

STANDARD CONSTRUCTION DETAIL
6" CONCRETE CURB AND 18" GUTTER

SCALE: 1"=1'-0"

REVISED: MAR 2013

P1

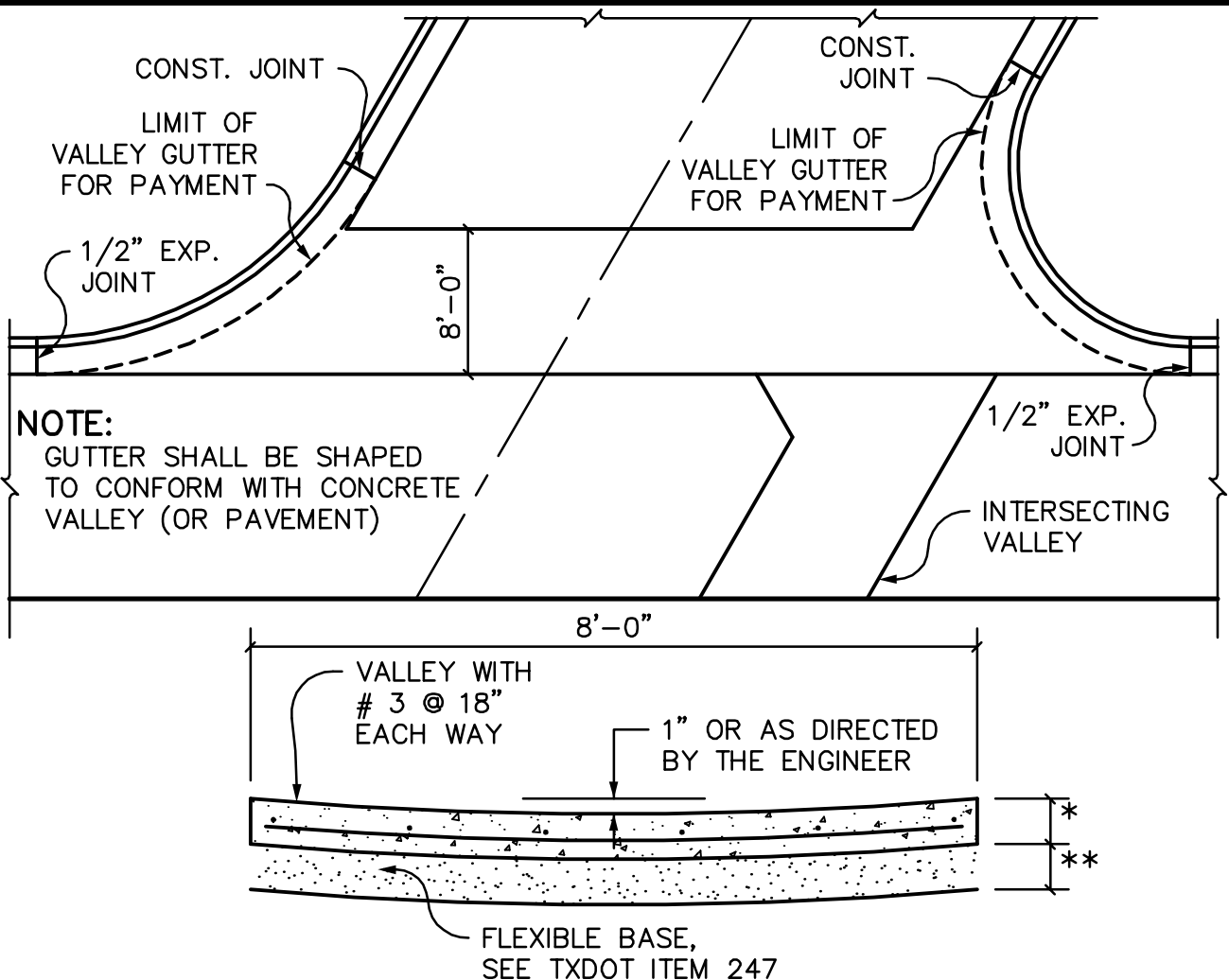

THE REINFORCED CONCRETE VALLEY SHALL REPLACE THE TOP OF THE PAVEMENT WITH THE REMAINING PORTION OF THE PAVEMENT TO BE CONSTRUCTED INCLUDING SUBGRADE TREATMENT, IN ACCORDANCE WITH THE TYPICAL PAVING SECTION. THE CONCRETE VALLEY WILL BE GOVERNED ACCORDING TO CITY STANDARDS FOR CONCRETE CURB AND GUTTER.

TRANSITION SECTION FOR VALLEYS CROSSING MAJOR STREETS	
DIST. FROM C/L OF DIP	CROWN
0 FT	0.000 FT
5 FT	0.041 FT
10 FT	0.083 FT
20 FT	0.208 FT
30 FT	0.333 FT
40 FT	0.458 FT
50 FT	0.500 FT

* 6" FOR LOCAL STREETS
7" FOR COLLECTOR STREETS
8" FOR ARTERIAL STREETS

** 8" FOR LOCAL STREETS
10" FOR COLLECTOR STREETS
10" FOR ARTERIAL STREETS



STANDARD CONSTRUCTION DETAIL
VALLEY GUTTER

SCALE: 1"=1'-0"
REVISED: MAR 2013
P2

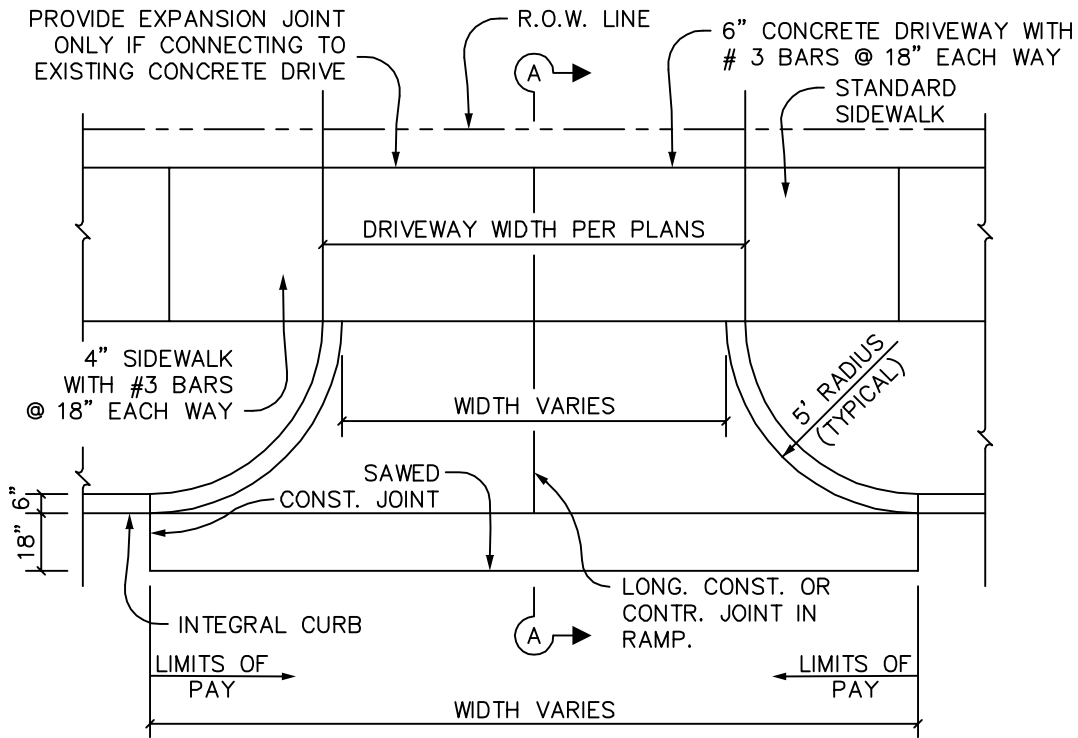

NOTE: EXISTING CURB AND GUTTER SHALL BE VERTICALLY SAWCUT. HORIZONTAL SAWCUTTING OF CURB NOT ALLOWED. REDWOOD OR FELT SHALL BE PLACED ON BOTH SIDES OF SAWED CONST. JOINT.

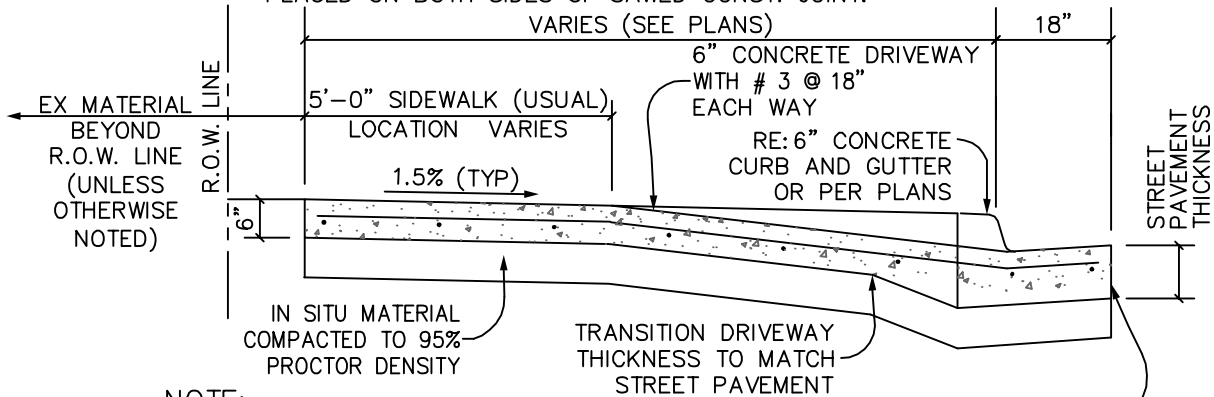

NOTE: SIDEWALK SECTION THROUGH DRIVEWAY SHALL BE POURED SAME THICKNESS AS DRIVEWAY APPROACH (EXISTING SIDEWALK, IF ANY, SHALL BE REMOVED AND REPLACED)

SECTION A-A

SEE CROSS-SECTIONS FOR DRIVEWAY GRADES



STANDARD CONSTRUCTION DETAIL

RESIDENTIAL DRIVEWAY

SCALE: N.T.S.

REVISED: MAY 2013

P3

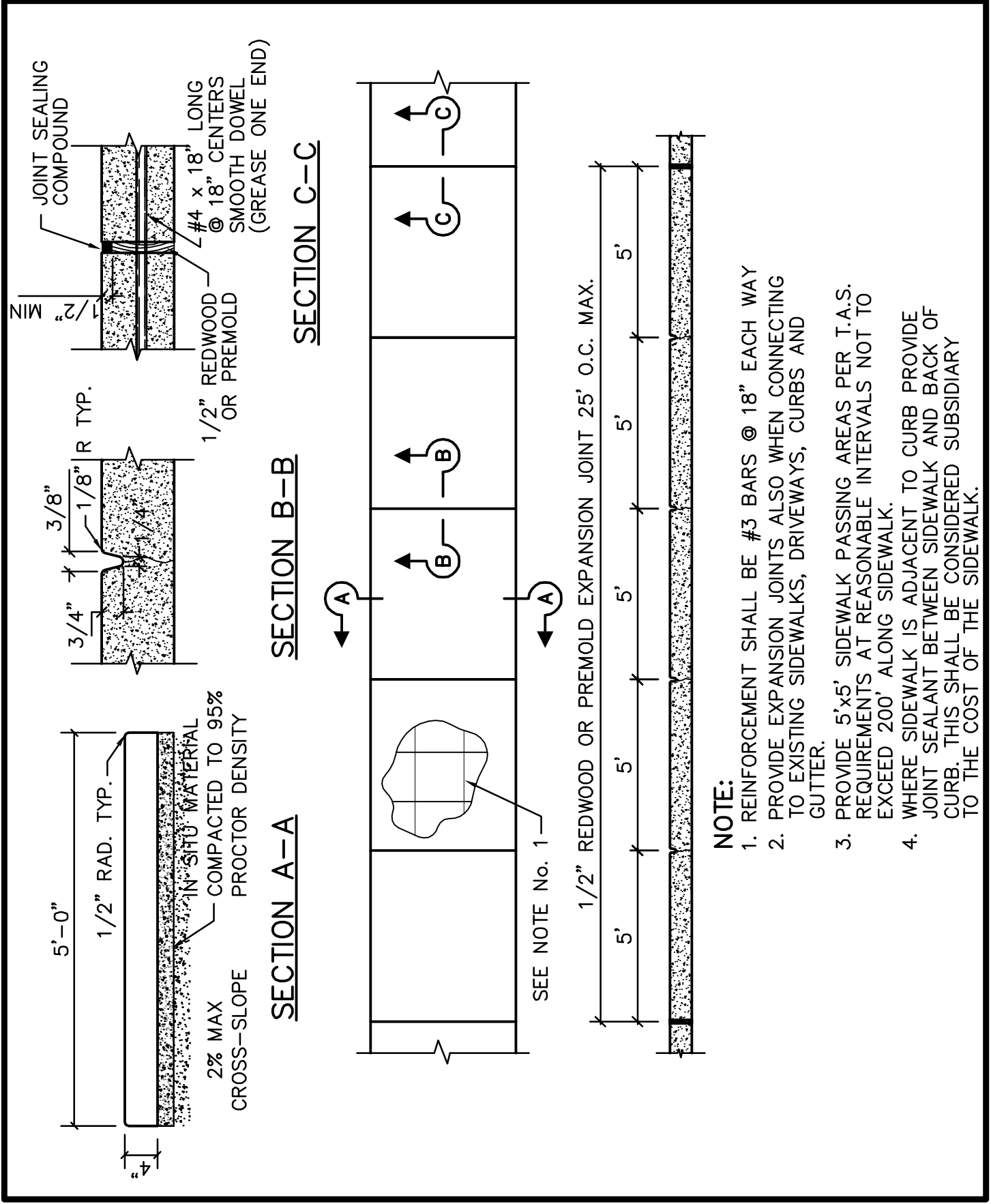

SECTION C-C

SECTION B-B

SECTION A-A

NOTE:

1. REINFORCEMENT SHALL BE #3 BARS @ 18" EACH WAY
2. PROVIDE EXPANSION JOINTS ALSO WHEN CONNECTING TO EXISTING SIDEWALKS, DRIVEWAYS, CURBS AND GUTTER.
3. PROVIDE 5'x5' SIDEWALK PASSING AREAS PER T.A.S. REQUIREMENTS AT REASONABLE INTERVALS NOT TO EXCEED 200' ALONG SIDEWALK.
4. WHERE SIDEWALK IS ADJACENT TO CURB PROVIDE JOINT SEALANT BETWEEN SIDEWALK AND BACK OF CURB. THIS SHALL BE CONSIDERED SUBSIDIARY TO THE COST OF THE SIDEWALK.



STANDARD CONSTRUCTION DETAIL
CONCRETE SIDEWALK

SCALE: 1"=1'-0"
 REVISED: MAR 2013
 P4

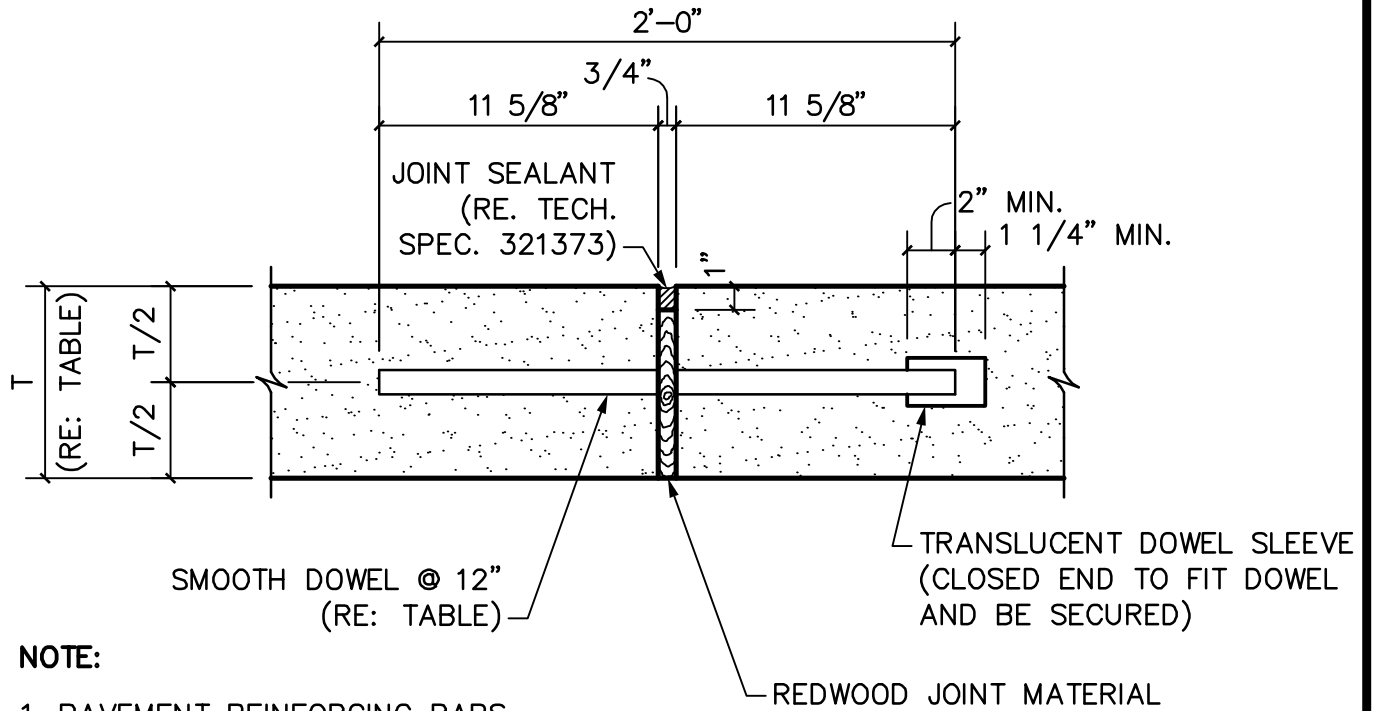

TABLE			
STREET CLASS	T (IN.)	DOWEL SIZE (IN.)	DOWEL LENGTH (L) (IN.)
A	9	1.0	24
B	8	1.0	24
C	7	0.75	24
D	6	0.75	24
E	6	0.75	24
F	6	0.75	24
G	6	0.75	24

NOTES:

- REFER TO TECHNICAL SPECIFICATION 321313 FOR CONCRETE PAVEMENT.
- CAPPED AND UNCAPPED ENDS SHALL ALTERNATE.
- DOWEL SUPPORT MATERIALS AND LAYOUT SHALL BE SUBMITTED TO THE CITY FOR REVIEW AND APPROVAL PRIOR TO ORDERING MATERIALS AND CONSTRUCTION.
- ENTIRE LENGTH OF DOWEL SHALL BE LUBRICATED.
- DOWELS MUST BE INSTALLED IN THE PAVEMENT PARALLEL TO THE PAVEMENT SURFACE AND TO THE CENTERLINE.



**STANDARD CONSTRUCTION DETAIL
CONCRETE PAVEMENT
EXPANSION JOINT**

SCALE: 1 1/2" = 1'-0"

REVISED: MAR 2012

P06

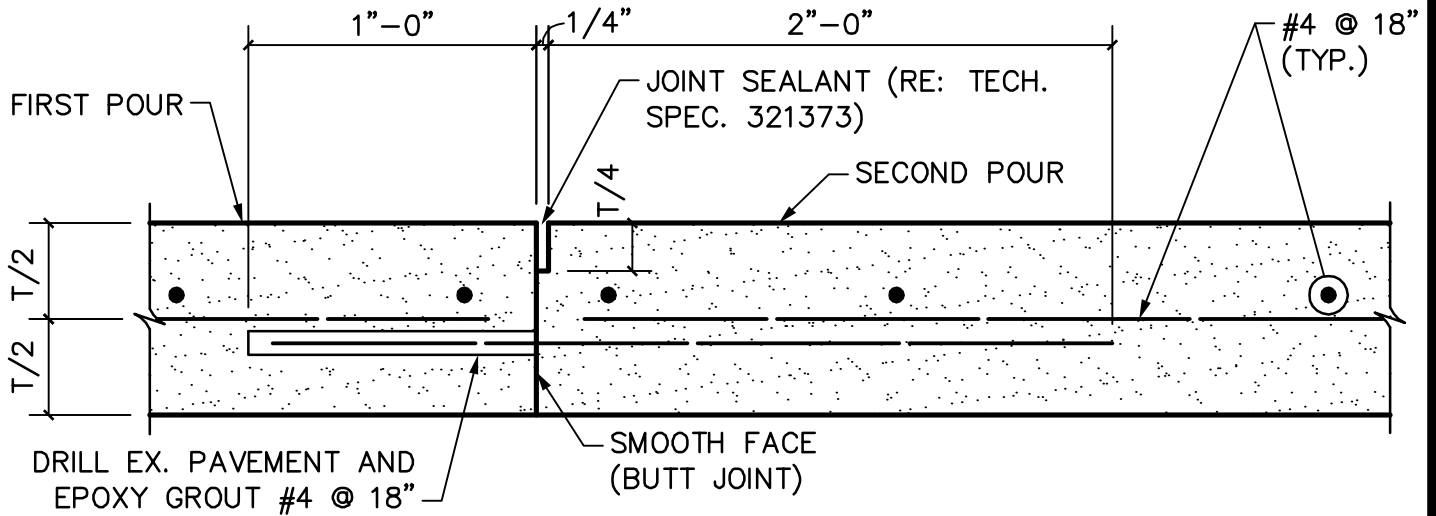

OPTION 1

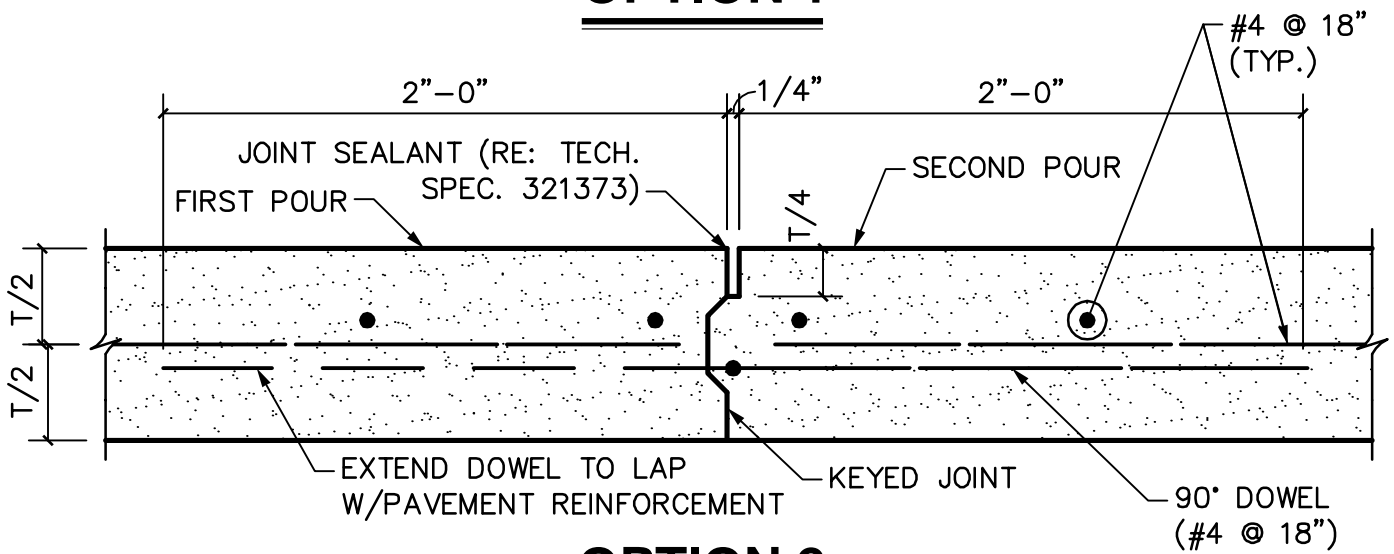

OPTION 2

NOTES:

1. REFER TO TECHNICAL SPECIFICATION 321313 FOR CONCRETE PAVEMENT
2. DOWELS MUST BE INSTALLED IN THE PAVEMENT PARALLEL TO THE PAVEMENT SURFACE.
3. DOWELS IN TRANSVERSE JOINTS MUST BE INSTALLED IN THE PAVEMENT PARALLEL TO THE PAVEMENT CENTERLINE.
4. DOWELS IN LONGITUDINAL JOINTS MUST BE INSTALLED IN THE PAVEMENT NORMAL TO THE PAVEMENT CENTERLINE.
5. BACKER ROD MATERIAL MAY BE USED IN CONJUNCTION WITH SEALANT IF THE JOINT SEALANT RESERVOIR MAINTAINS AT LEAST A 1:1 WIDTH/DEPTH RATIO, BUT IN NO CASE SHALL THE RATIO BE GREATER THAN 1:15. THE BACKER ROD DIAMETER SHALL BE 1/8" GREATER THAN THE JOINT WIDTH.



STANDARD CONSTRUCTION DETAIL CONCRETE PAVEMENT CONSTRUCTION JOINTS

SCALE: 1 1/2" = 1'-0"

REVISED: MAR 2012

P06

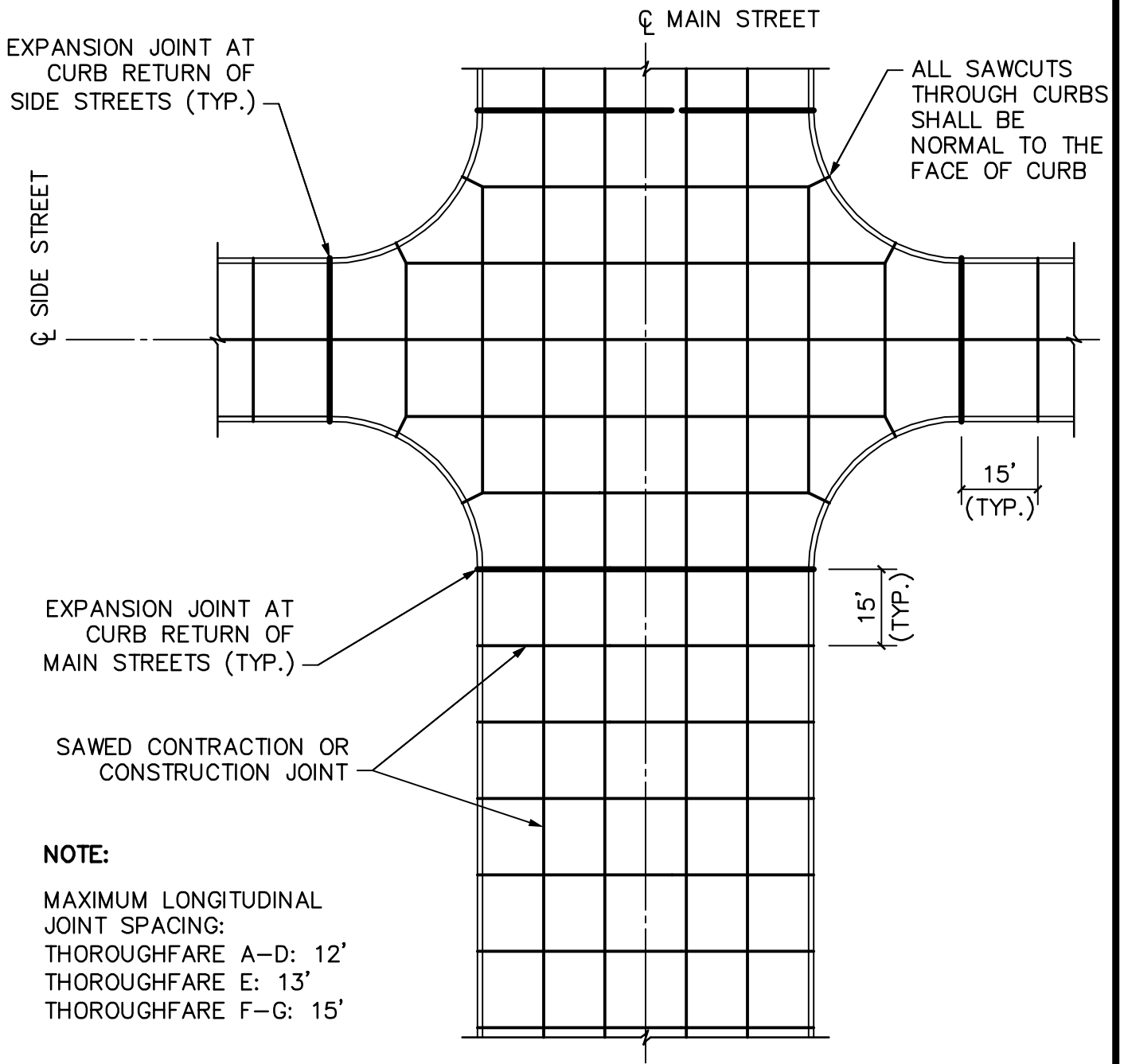

NOTE:

MAXIMUM LONGITUDINAL JOINT SPACING:
 THOROUGHFARE A-D: 12'
 THOROUGHFARE E: 13'
 THOROUGHFARE F-G: 15'

NOTES:

1. REFER TO TECHNICAL SPECIFICATION 321313 FOR CONCRETE PAVEMENT.
2. ALL PAVEMENT JOINTS ARE EITHER SAWED CONTRACTION OR CONSTRUCTION JOINTS UNLESS NOTED OTHERWISE.
3. MAXIMUM TRANSVERSE JOINT SPACING IS 15'.
4. LONGITUDINAL JOINT SPACING SHALL MATCH LANE LINES UNLESS NOTED OTHERWISE.
5. ALL SAWCUTS SHALL BE 1/8" TO 3/16" WIDE AND ONE-FOURTH THE DEPTH OF THE ACTUAL SLAB THICKNESS.
6. ALL PAVEMENT JOINTS SHALL BE SEALED. JOINT SEALANT SHALL BE PROVIDED IN ACCORDANCE TECHNICAL SPECIFICATION 321373.



**STANDARD CONSTRUCTION DETAIL
 CONCRETE PAVEMENT
 JOINTING LAYOUT**

SCALE: 1"=30'

REVISED: MAR 2012

P10